

One Heart, One Vision, One Purpose.

Building to shape learning for the future



Sacré Cœur

Sacré Cœur Women Shape the World



Discover how we are transforming our educational landscape

At Sacré Cœur, we are focused on creating accessible, agile and innovative learning environments for our students and staff.

We are therefore delighted to unveil plans for a new state-of-the-art Resource, Science, Technology and Creative Arts Building. Construction is expected to commence in 2019.

This exciting project is part of a new broader School Master Plan that will provide for the ongoing strategic management, development and maintenance of our buildings and beautiful grounds.

The new facility, to be located in the heart of our campus, will be a keystone for our learning community. It will provide critical physical infrastructure for Sacré Cœur's innovative practice and leading edge programs, replacing our existing science building and staff room.

The new Resource, Science, Technology and Creative Arts Building will provide critical physical infrastructure for our innovative practice and leading edge education programs. The building will enhance and support a creative use of space, and provide flexible and adaptive areas that address current capacity needs.

The spaces in the building will provide important linkages across the campus to create a network of integrated learning communities; bringing together science, technology, engineering, creative arts, and mathematics. It will encourage students to pursue their learning passions with all of these options integrated. Throughout the building will be different learning space options, which encourage small groups to break out and provide opportunities for collaboration. The top level of the building will provide flexible learning spaces.

The proposed building will appear as an elongated and gentle curve that mediates between the existing buildings. The facility will span four levels and be of a significant scale, although sited recessively so that it will not be visible from the Burke Road elevation above the ridge of the Main Wing.

The facility will sensitively connect directly into the rear of the Main Wing at the west end, and into the Janet Erskine Stuart Centre at the east end.

Each end of the new building will have stairs and passenger lifts that will provide quick vertical transport and universal access to the adjacent buildings. Additional Joigny facilities will be on the Ground Floor.

Some of the key features of this building project will include:

- Highly innovative and flexible indoor and outdoor learning spaces, bringing together science, technology, engineering, creative arts, and mathematics.
- New Library and Science Laboratory facilities.
- Additional Joigny facilities.
- New staff collegial spaces.
- Highly sensitive connections to existing heritage buildings.
- Environmentally sustainable design.



Proposed Ground Floor

Environmentally sustainable design provisions to be explored will include passive design and natural ventilation principles, daylight lighting and glare control, rainwater collection, stormwater detention and reuse, photovoltaics, efficient construction systems, and materials with recyclability and low volatile organic compounds.

As part of the project, the Ground Floor of the Dorothy McGuinness Centre, which currently houses the existing Library, will be converted into new staff collegial work spaces.

- | | | | | |
|-------------------------|-------------------|---------------|---------------|---------------------|
| 1 Breakout Covered Play | 3 Joigny Library | 5 Store | 7 Circulation | 9 Multipurpose Room |
| 2 Joigny Play | 4 Covered Walkway | 6 Science Lab | 8 Store | |

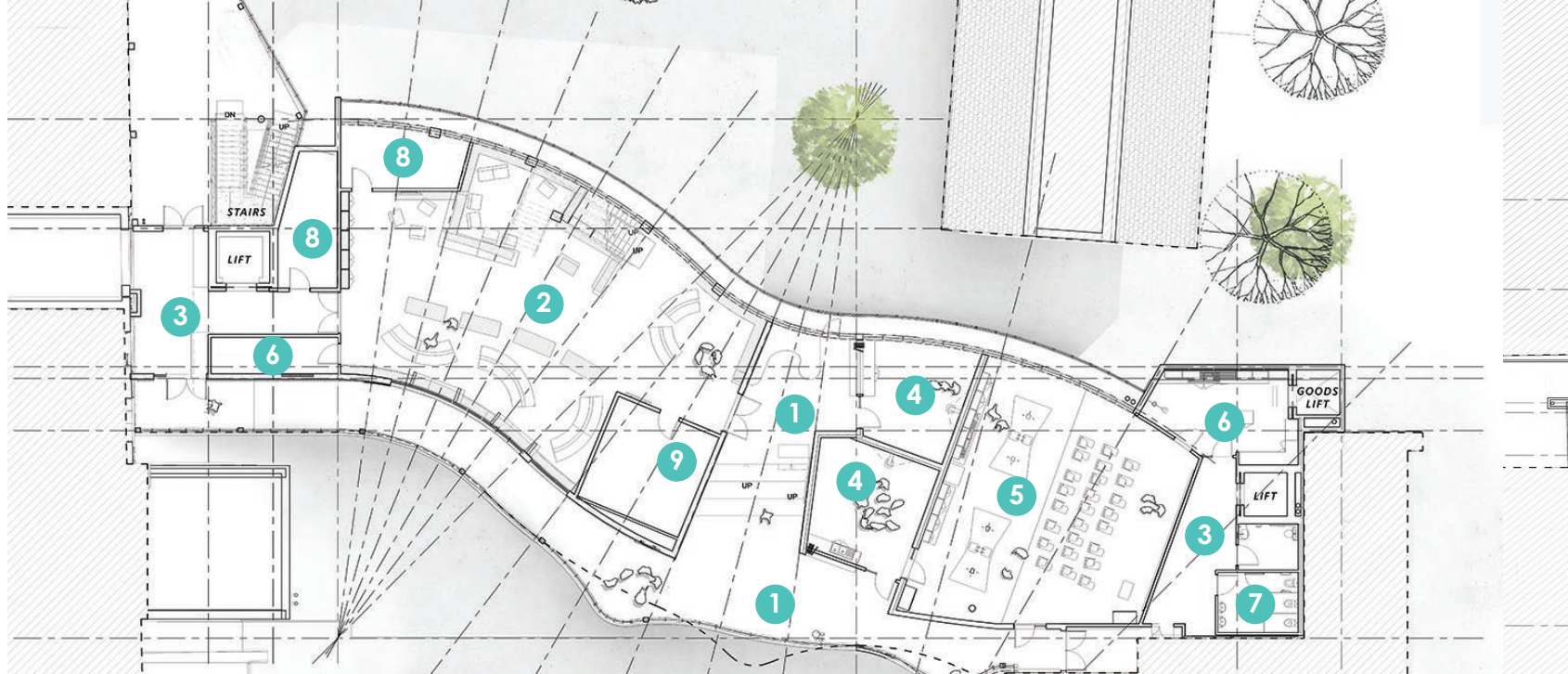

Proposed First Floor

The First and Second floors will house the new Library and will have internal stairs linking its two levels. Science labs are on each of the Ground, First and Second floors, and these rooms will have adjacent indoor and outdoor breakout spaces.

- | | | | | |
|-----------------|------------|---------|-----------|----------|
| 1 Open Breakout | 3 Hallway | 5 Lab | 7 Toilets | 9 VR Lab |
| 2 Library | 4 Breakout | 6 Store | 8 Office | |

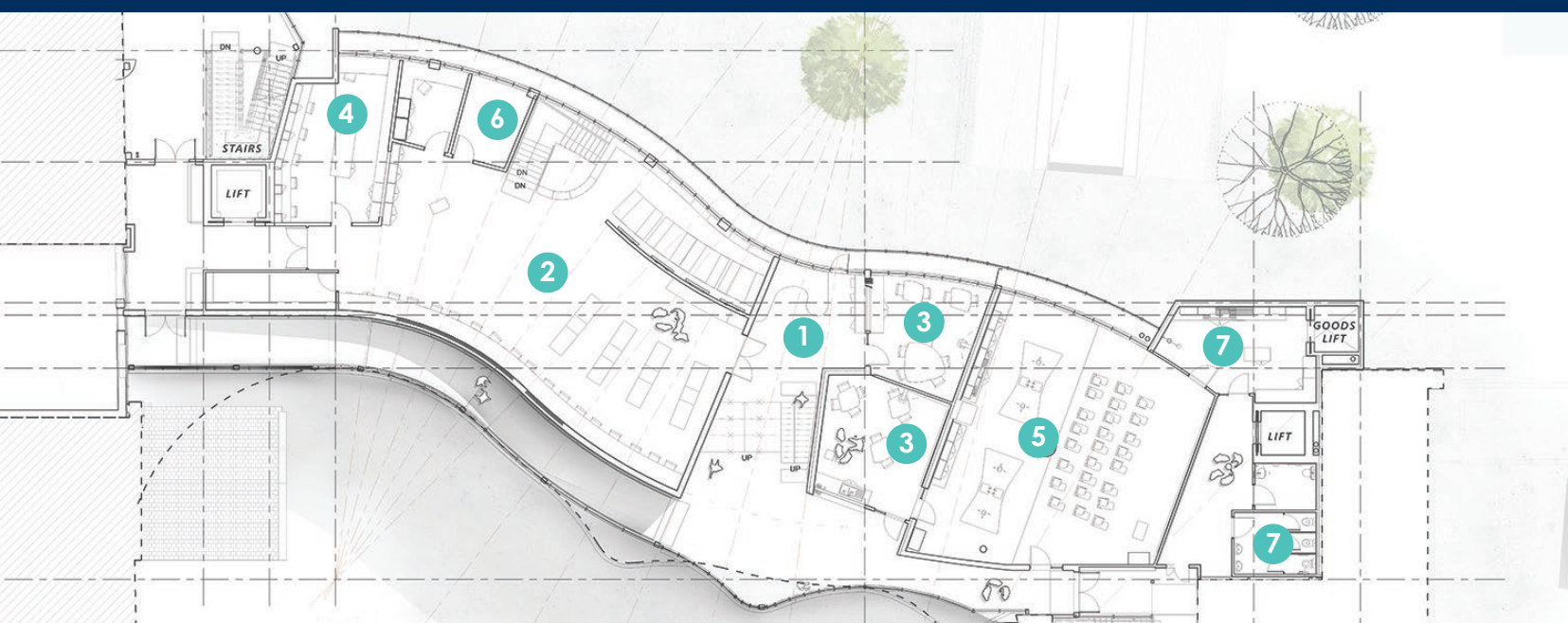

Proposed Second Floor

The First and Second floors will each have an internal street with stopping points and breakout spaces that meld into the building's central and outdoor breakout spaces, linking together the Library with the informal, general and specialist learning areas. These internal streets connect the Main Wing to the Janet Erskine Stuart Centre.

- | | | | |
|--------------------|------------|-----------|-----------|
| 1 Outdoor Breakout | 3 Breakout | 5 Lab | 7 Toilets |
| 2 Library | 4 Workroom | 6 Meeting | |



Proposed Third Floor

The Third Floor will have an outdoor space with an open deck, views and landscaping; and indoor spaces that can be utilised for creative arts, engineering and digital design. Each level will have new amenities at the Janet Erskine Stuart Centre end. There will also be new locker and outdoor learning spaces added to the eastern classrooms of the Main Wing.

- | | | | | | |
|--------------|---------------------------|----------------|--------------------|--------------------|-----------------------|
| 1 Studio One | 3 Digital Tech Studio | 5 Open Walkway | 7 Outdoor Learning | 9 Media Store Room | 11 Photography Studio |
| 2 Studio Two | 4 Outdoor Covered Walkway | 6 Open Deck | 8 Toilets | 10 Print Room EQ | |





About the Architects

H E
ARCHITECTS
D E

The building will be designed by Hede Architects.

Hede Architects is an award winning practice that has been creating unique solutions and designing schools for a large range of students for over 30 years.

The practice works with a range of pedagogies, all of which are aimed at creating self-initiated learning in a safe, flexible, inspiring environment. Their dedicated team of architects work on each project, and each team

member has areas of specialisation so that the project can benefit from the latest in design technologies and innovation.

Hede Architects is committed to the development of the brief with the client and users of the building, designing from the inside out so that the pedagogy of our School is expertly reflected in the design.

For more information about Hede Architects visit hedearchitects.com.au

Support our Buildings and Grounds

Giving to Sacré Cœur has the power to change lives and build futures.

Sacré Cœur's Foundation Building Fund ensures that generous and continuing donor support helps us to transform our buildings and grounds for generations of students and staff, while maintaining our heritage and history.

We invite you to make a difference and support our buildings and grounds development programs by completing and sending us a giving form.

DONOR INFORMATION

Full name(s)			
Address			
	State	Postcode	Country
Telephone	Home	Business	Mobile
Email	Home		
	Business		
Affiliation	<input type="radio"/> Past Student - Year of leaving <input type="radio"/> Past Parent <input type="radio"/> Current Parent <input type="radio"/> Staff		
	<input type="radio"/> Other		
<input type="radio"/> Please direct my/our gift towards the tax deductible Sacré Cœur Foundation Building Fund			
Please accept my/our gift of <input type="radio"/> \$100 <input type="radio"/> \$200 <input type="radio"/> \$500 <input type="radio"/> \$1,000			
<input type="radio"/> Other amount \$			

METHOD OF PAYMENT

<input type="radio"/> Cheque enclosed (Made payable to the Sacré Cœur Foundation Building Fund)	
<input type="radio"/> Credit card	<input type="radio"/> Visa <input type="radio"/> Mastercard <input type="radio"/> Amex
Name on credit card	
Card number	Expiry date /
Authorised payment amount \$	Cardholder's signature

GIFT RECOGNITION

Every donor and supporter will be acknowledged and recognised in a special way by the Foundation, unless you wish to remain anonymous. Gift amounts remain confidential. Please indicate how you would like your name/s to appear on our donor list:

☐ I wish for my/our donation to remain anonymous. Please do not include my/our name in publications.

ADDITIONAL INFORMATION

- ☐ Please send me information about including the Foundation in my will.
- ☐ I have already made arrangements to include the Foundation in my will.

PLEASE RETURN THIS DONATION FORM WITH YOUR GIFT TO

Sacré Cœur Foundation Limited, Reply Paid 86294, Glen Iris Victoria 3146 Australia or email foundation@sac.vic.edu.au
Please contact us on +61 3 9835 2776 if you would like to make your gift over the phone.

All donations to the Sacré Cœur Foundation's Building Fund over \$2 are tax deductible.

Privacy: The information is collected and used within the guidelines of the National Privacy Principles under the relevant Australian privacy legislation. For further information please refer to the School's privacy policy and collection notice on our website.



Sacré Cœur
Sacré Cœur Women Shape the World

For further information about this project visit sac.vic.edu.au/masterplan

Sacré Cœur | 172 Burke Road Glen Iris | +61 3 9835 2700